

THE
A D D R E S S
—
SIAM - RATCHATHEWI

STATELY LUXURY LEISURE





HOW YOU RELAX DECLARES WHO YOU ARE



Behind every square inch of **THE ADDRESS**
is the quintessential philosophy of 'Luxury Leisure'.

Fusing an attitude of 'Elegance' with the ease of 'Leisure Living',
the concept permeates all aspects of the property and gives rise
to the unique living etiquette that sets it apart.



LUXURY IS AN EMOTION



Profound and exquisite in essence, the ‘Luxury Leisure’ concept looks at how architecture and interior design can create new, never-before-experienced emotional indulgences.

The first-ever condominium to be founded on this concept, **THE ADDRESS** has been methodically designed to explore every angle of leisurely activities. And complementing this ethos is the formality of the architecture and interior style that brings to mind the highly refined court life of a bygone age.

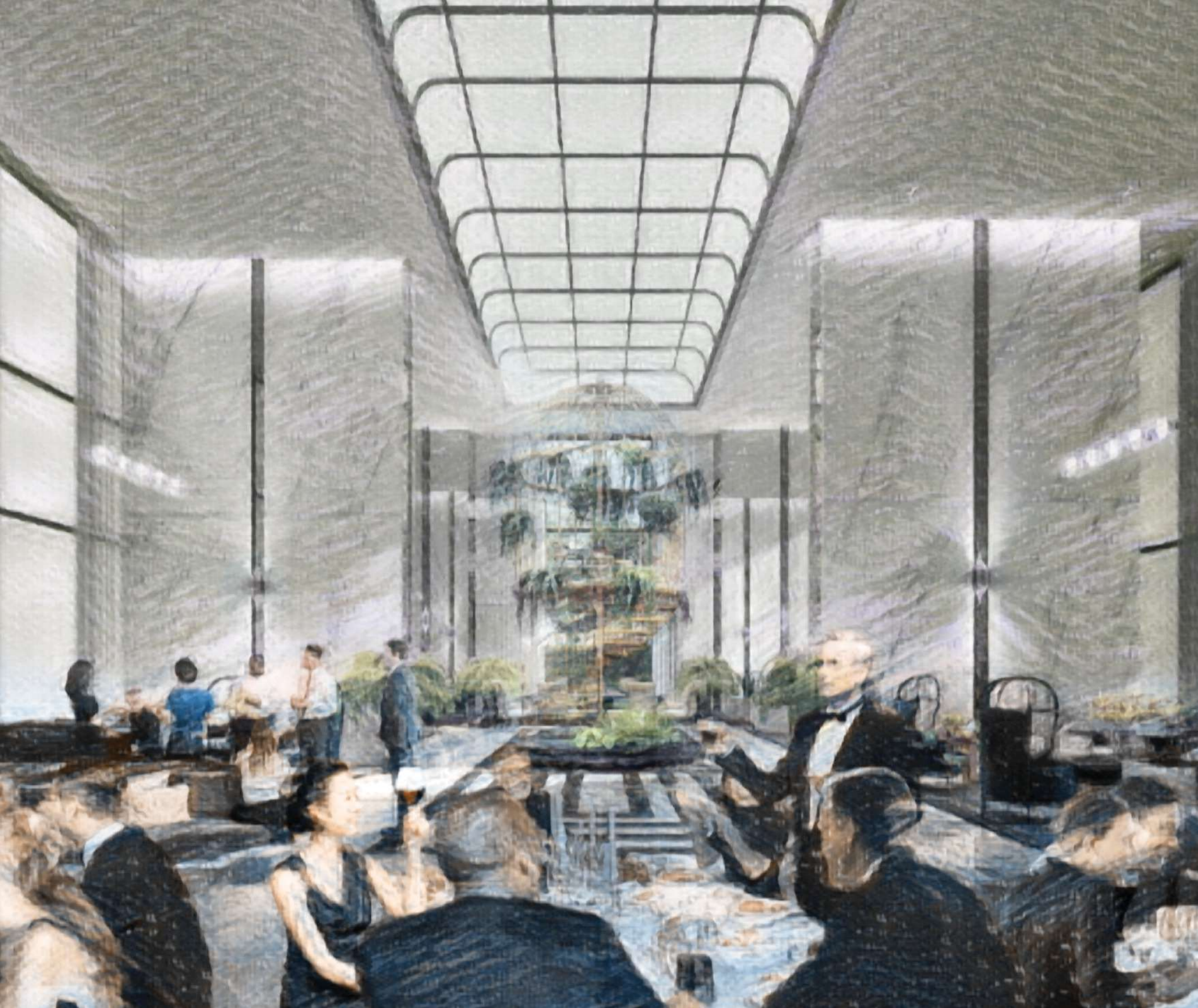

STATELY STATE OF MIND



‘Stately Symmetry’ layouts and interior style exude an air of European court grandeur. Throughout the interior space, every vista point, every corridor, every ornamental wall is symmetric in design, giving the residence an impeccable feel of formality.

This, together with a flawless functionality focused on leisurely living, informs the unique identity of **THE ADDRESS**.



*SIMULATED IMAGE IS FOR ADVERTISING PURPOSE ONLY

THE ULTIMATE LUXURY LEISURE



Home is where you should be free to do things in your own way and at your own pace.

With this in mind, we have designed all private residential units to ensure your ultimate luxury leisurely living.

With a ceiling height of over 5.8 metres, the living room of each duplex has floor-to-ceiling glass walls that let in abundant light to give your home an added feeling of spaciousness while surrounding you with breathtaking views of the heart of Bangkok.

The kitchen runs the length of an entire wall and comes with shutter panels, allowing you to turn the cooking area into an elegant part of the living room.



*SIMULATED IMAGE IS FOR ADVERTISING PURPOSE ONLY.

With flexibility, life becomes easier and more comfortable.

All one- and two-bedroom residences are ultra-luxurious in design, with a ceiling height of over 3 metres and a double-skin balcony that lets you enjoy extra indoor living space when you choose.

A separate, walled-off kitchen closes the door on unwanted cooking smells.

The layouts also emphasise total separation between the shared area - the living room - and private space - the bedrooms - ensuring a sense of supreme privacy.

LEISURE AT EVERY STEP



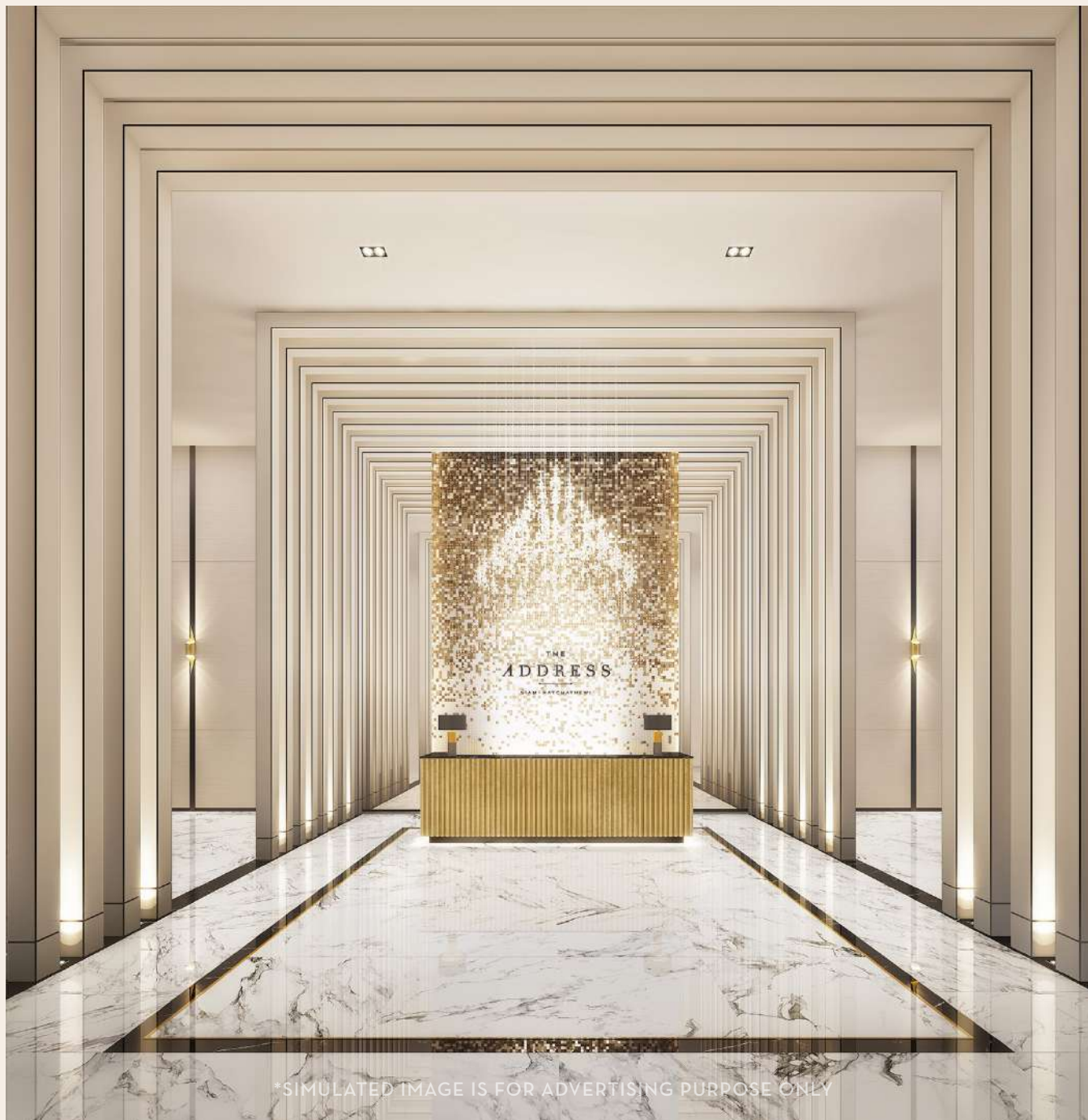

*SIMULATED IMAGE IS FOR ADVERTISING PURPOSE ONLY

THE CONCIERGE GALERIE



The spacious main entrance hall exudes a grand yet intimate welcome. Magnificent in both scale and design, it epitomises the perfect union between formal luxury and a serene, modernistic aesthetic.

*SIMULATED IMAGE IS FOR ADVERTISING PURPOSE ONLY

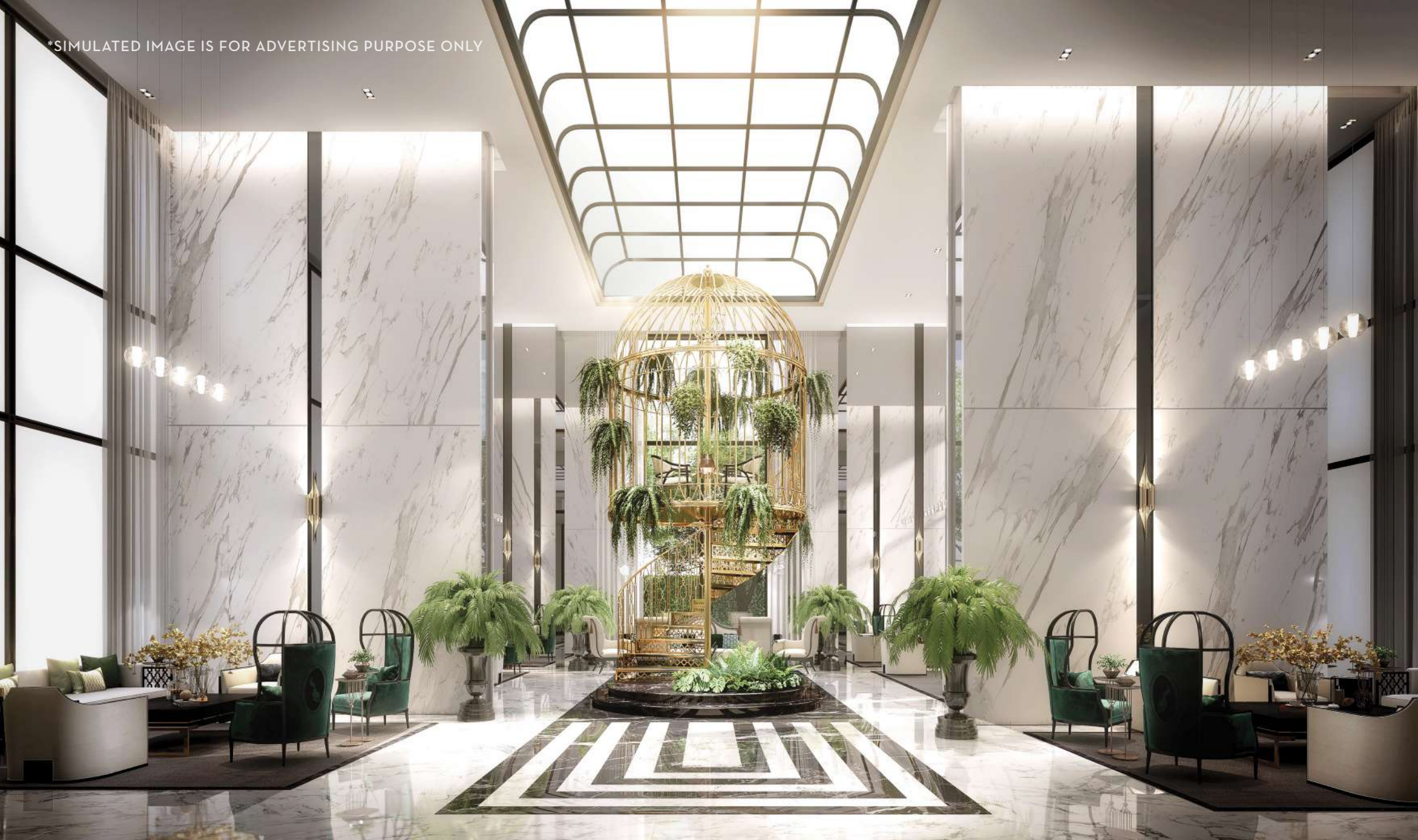

THE GRANDE CHAMBER



With a ceiling height of 8 metres, the main reception hall is the largest indoor space on the property.

Its interior pays tribute to the splendour of a bygone era, the symmetry of the design complemented by the generous seating layout and impeccable choice of materials. Soaring walls of white Statuario marble from Carrara, the most highly prized variety found in Italy, set the tone of exclusivity, its distinctive patterns adding to the lounge's aesthetic appeal.

*SIMULATED IMAGE IS FOR ADVERTISING PURPOSE ONLY



THE BLUE SALOON



Luxe in its design essence, as exemplified by an interior palette of regal blues, the lounge is at once welcoming and relaxing, simultaneously ready to impress and put everyone at ease. Sweeping views of the lush great lawn outside make the space truly one of a kind.

*SIMULATED IMAGE IS FOR ADVERTISING PURPOSE ONLY



THE GREAT LAWN



Bringing to mind the elegant formality of landscaped gardens at stately homes, the rectangular court of perfectly manicured grass is dotted with flowering plants that perfume the air from morning to night.

Relax on the oversized lounging facilities and let your senses be soothed by the calming scenery.

SIMULATED IMAGE IS FOR ADVERTISING PURPOSES ONLY



THE RIVER SALA



Nestled between elongated ponds at the end of a garden corridor, the Sala is a peaceful spot perfect for a quick rejuvenating rest or a long contemplative one.

SIMULATED IMAGE IS FOR ADVERTISING PURPOSE ONLY



THE HIGH GARDEN



A green relaxation area situated on the 9th floor, the garden provides a unique vantage point for enjoying beautiful nature and the refreshing feel of the wind.

*SIMULATED IMAGE IS FOR ADVERTISING PURPOSE ONLY



THE SKY OASIS



Perched high over the hustle and bustle of the city, this lush oasis offers panoramic views from 50 storeys above the ground and becomes truly spectacular at sunset. The perfect place to calm your mind and ignite your spirit.

*SIMULATED IMAGE IS FOR ADVERTISING PURPOSE ONLY



THE SKY POOL



Located on the 50th floor, the magnificent 50-metre saltwater pool is the place to be when you need to reenergize or simply rest and recharge. Put yourself through the paces of a challenging water workout or unwind with a relaxing swim. A hydrotherapy zone is nearby to ensure relief from aches and pains.

After your pool session, sit semi-outdoor at The Sky Bar.

Drink in the views and let the cool breezes help you feel one with the world once more.

*SIMULATED IMAGE IS FOR ADVERTISING PURPOSE ONLY



THE SKY CHAMBER



Floating over the Sky Pool, the most ornate room in the residence is made for leisurely lounging with a décor crafted from the finest materials from Maison Hermès including signature armchairs and opulent wall coverings by Hermès Furnishing Fabrics and Wallpapers.

SIMULATED IMAGE IS FOR ADVERTISING PURPOSE ONLY



THE CLOUD FITNESS



With breathtaking views of the city visible through glass walls, our fitness facility is designed to make staying fit a joy. Private fitness cubes fitted with treadmills let you wall yourself off from your workout neighbours and focus on your own exercise. The cutting-edge exercise innovation, the Kinesis lets you choose from more than 200 different exercises to meet your fitness goals.

PROJECT DETAIL



Land Area

3 - 1 - 55 Rais

Project Type

50 - Storey Building

Total Unit

880 Residential Units

Unit Type

1 Bedroom	31.0 - 35.0 sq.m.
1 Bedroom Duplex	50.0 sq.m.
2 Bedroom	51.5 - 69.5 sq.m.
2 Bedroom Duplex	65.0 sq.m.
3 Bedroom	86.0 sq.m.

Facilities

Ground Floor

The Concierge Galerie

The Grande Chamber

The Blue Saloon

The Great Lawn

The River Sala

9th Floor

The High Garden

The Gym

50th Floor

The Sky Oasis

The Sky Library

The Sky Chamber

The Sky Bar

The Cloud Fitness

The Sky Pool

(with hydrotherapy & Kid's Pool)



*SIMULATED IMAGE IS FOR ADVERTISING PURPOSE ONLY

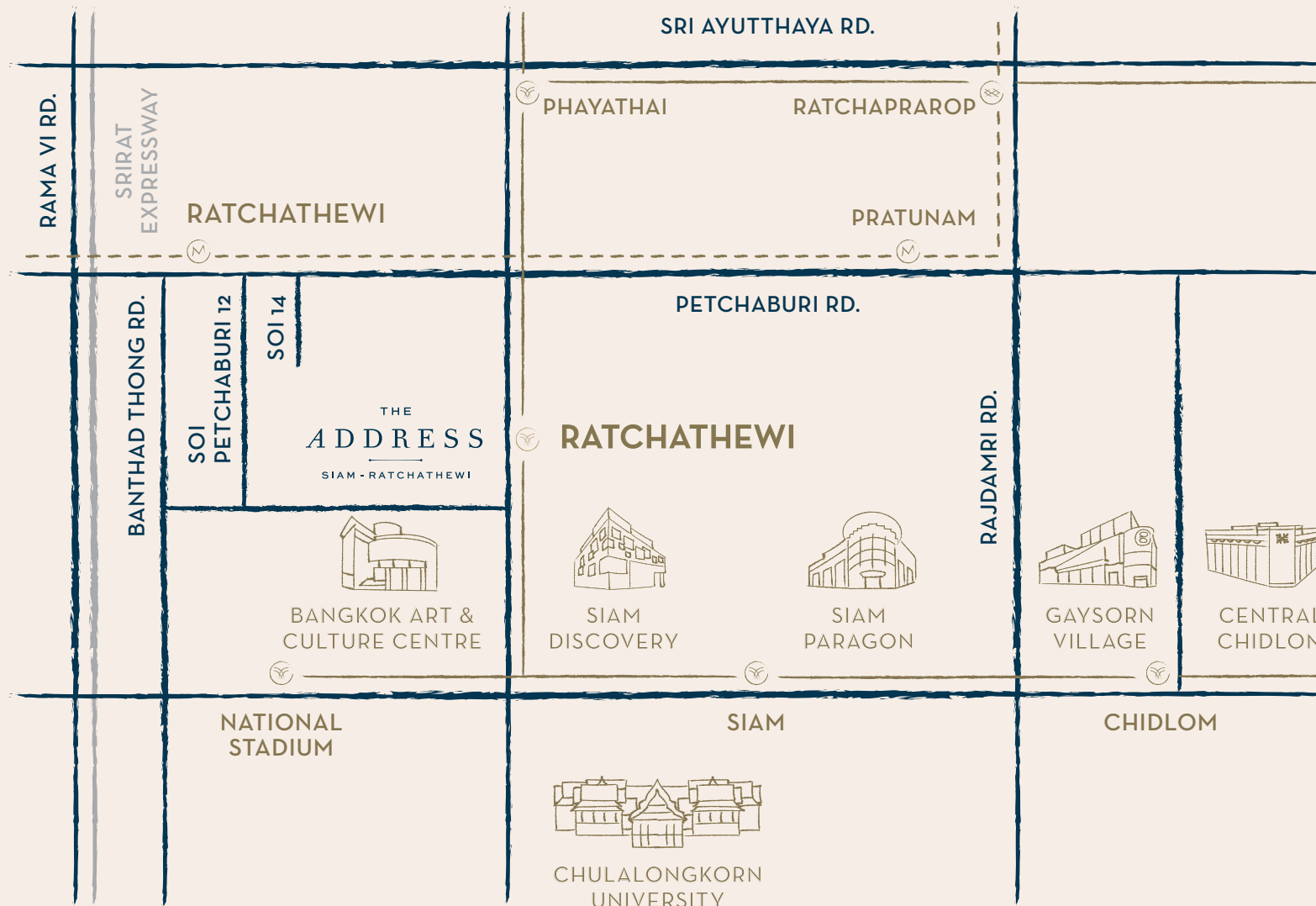

RIGHT IN THE HEART OF IT ALL

THE ADDRESS places you in the midst of action, right in the centre of Bangkok's most vibrant neighbourhood.

LOCATION ADVANTAGE

BTS Ratchathewi Station - Bangkok's modern and efficient elevated train system is just a few steps away.

Two nearby expressways and multiple road shortcuts - easy access for car travel to anyway in Bangkok.

PARAGON OF FINE LIFESTYLE

Siam Paragon and Siam Square - the city's premier high-end shopping and dining district - is one BTS Station away.

ACCESS TO ICONIC DESTINATIONS

Within 5 minute-radius, there are 23 hospitals, 19 leading education establishments, 19 department stores, 15 art galleries and 150 restaurants.

